



HOSTED BY



ORGANIZED BY



2007 STUDENT LANDSCAPE ARCHITECTURE DESIGN COMPETITION PRIZE WINNERS

FIRST PRIZE <i>IFLA Group Han Prize for Student Landscape Architecture</i>	TITLE <i>PEACE Walls</i> AUTHOR(S) Kim Suk-Ha, Ha Min-Ho, Kang Han-Duck, Yun Ryu-Kyung INSTITUTION University of Seoul, Seoul, Korea
SECOND PRIZE <i>IFLA Zvi Miller Prize</i>	TITLE <i>Islandisland</i> AUTHOR(S) Kwon Yu, Shin Joon-ho, Kim Hyo-jun, Lee Ji-hyun, Kwon Jung-sam INSTITUTION University of Seoul, Seoul, Korea
THIRD PRIZE <i>Merit Award</i>	TITLE <i>Econtinuity: bringing back the future</i> AUTHOR(S) Gullyawat Lertpeerakon, Anon Chitranukroh, Patsorn Kiattipongtilaworn, Sorakit Kitcharoenroj, Pranot Jarvanrattanaprapa INSTITUTION Chulalongkorn University, Bangkok, Thailand
JURY AWARD	TITLE <i>Creating greenery at sky level – vertical park</i> AUTHOR(S) Mohd Khairul Azhar Bin Mat Sulaiman, Mohd Fairuz Shahidan, Naeemah Yusof, Lee Cheng Teik INSTITUTION University Putra Malaysia, Kuala Lumpur, Malaysia
JURY AWARD	TITLE <i>Eye on the Faces of One Waste Dump</i> AUTHOR(S) Guo Yong, Zhang Yang INSTITUTION Department of Landscape Architecture, Tsinghua University, Beijing, China
JURY AWARD	TITLE <i>The Plan to Convert NT to the cemetery</i> AUTHOR(S) Takashi Kishi, Kazuhito Koike, Mashito Chashegawa, Tomomi Kaizum, Yoshima Koyama INSTITUTION Tokyo University, Setagaya-ku, Tokyo, Japan
JURY AWARD	TITLE <i>Skyline Conservation Strategies for Kuala Pilah Town Centre</i> AUTHOR(S) Nurulhuda Bt Abdul Hamid Yusoff INSTITUTION Universiti Teknologi MARA, Shah Alam, Malaysia

JURY AWARD	TITLE AUTHOR(S) INSTITUTION	<i>Vitalizing Maasvalley</i> C. Oude Aarninkhof, M. Galdon, M. Slob Department of Landscape Architecture, Wageningen University and Research Centre, Wageningen, Netherlands
JURY AWARD	TITLE AUTHOR(S) INSTITUTION	<i>Life Revival on Rooftops</i> Aida Abolahrar, Atieh Ghafouri, Safira Mohammadi, Amir Sarafraznikoo, Davood Zadmehr Shahid Beheshti University, Tehran, Iran
JURY AWARD	TITLE AUTHOR(S) INSTITUTION	<i>Time and Space as Dynamic Elements in Sustainable Brownfield Landscape Planning and Design</i> Jennifer Dowdell, Dave LaClergue, Rebekah Van Wieren, Emily Marshall University of Michigan, Ann Arbor, USA

FIRST PRIZE <i>IFLA Group Han Prize for Student Landscape Architecture</i>	TITLE AUTHOR(S) INSTITUTION	<i>PEACE Walls</i> Kim Suk-Ha, Ha Min-Ho, Kang Han-Duck, Yun Ryu-Kyung University of Seoul, Seoul, Korea
--	--	--

JURY NOTES

This project involved the transformation of a former defensive wall to a memorial site, through a design plan to achieve the reunification of Korea. The entrants used a sensitive approach to a difficult physical problem and one considering a complex symbolic element. The design incorporates community functions and infrastructure, which will be connected to the ecological system.

The concept is very rich, and includes proposals for direct involvement by visitors. The elements in the proposal are clearly presented. The graphic communication is excellent, and many illustrations are presented in an effective way. The presentation involves many types of drawings, diagrams, and visualization, used to good advantage.

The jury commends the entrants for taking on a complex and sensitive project, and for the sophisticated design resolution.

In South Korea, there is a very huge barrier for defense from invasion of North Korea. Its name is "THE DEFENSIVE WALL Against Tank".

As it was established in the capital city of South Korea (Seoul), "THE DEFENSIVE WALL Against Tank" that was erected as a barrier have been referred to the other "Truce line of Korea" in Seoul. And it turned the War to an peace in South Korea as well as becoming "The Coexistence Monument" of South Korea. It even with the painful memory of the "Korean War".

Coincidentally, the WALL is about to be removed as the nation is moving into the time of peace through... The sunshine policy. But our design plan is how to remove it into park.

PROLOGUE "THE DEFENSIVE WALL Against Tank" has its value as the scene related to peace of Korea, the final country with the Division within so we plan to make it a part as the bridge to the Unification of Korean. Raising the possibility as a park, 'Symbol of Peace'

THE other Truce Line of Korea in Seoul
"THE DEFENSIVE WALL Against Tank"

PEACE walls seoul , korea

The long of all people for Unification of Korea

THE DEFENSIVE WALL Against Tank → THE PEACE walls for Unification of KOREAN

EDENING PLAN : DESIGN PLAN FOR ACHIEVE UNIFICATION OF KOREAN

DESIGN A SCENARIO FOR ACHIEVE UNIFICATION OF KOREAN

- the feeling of closeness
- the feeling of environmental
- the feeling of longing for Korea Unification

Let's enhance people's longing for Unification of Korean

Making PEACE WALL by organizing unit
organized by the rule of topography/past shape of the wall and nature

New expenditure & programs

STRUCTURE
Concrete structure into wall
SCALE OF STRUCTURE
Humanistic scale (200 x 200)

PROGRAM OF THE MEMORIAL ROLE
remains the shape of past one, the wall over which the weak condition

HAND PRINT / LCD VIEWER PROGRAM
give a chance to people to write on the side of each wall, view information about Unification

LANDSCAPE
landscapes made by people accumulated longing for Unification

link community
community function in the interface

MASTER PLAN
The wall direction is... a large number of unit of 20x400mm steel to grant various wall paper record program

Consequently, it records 100,000 writes that long for unification, and 100,000 units are accumulated as lines passes by that the great views to accessible may be produced.
The design is not completed by the landscaper.
The landscaper simply presents the whole drawing paper and the production of the scene is made up by the users for the one and only longing of all people. It is to build up the specific view by people.

scale 1 : 1

We felt the attraction to the life on reflecting the unique social image of Korea and worldwide spatial nature as the last remains of the Cold War era. And we undertook the design with the least obstacle to achieve the unification through the scenic view building up and accumulated scenic reflection through the site landscape design plan. The attempt is made to make the place as the national park, Mt. Incheon, and world famous site.

The other Truce Line of Korea in Seoul

In South Korea, there is a very huge barrier for defense from invasion of North Korea. Its name is 'THE DEFENSIVE WALL Against Tank'.

As it was established in the capital city of South Korea, (Seoul), 'THE DEFENSIVE WALL Against Tank' that was erected in 1970s have been referred to the other 'Truce line of Korea' in Seoul. And it reminds the War to all people in South Korea as well as becoming 'The Coldwar Monument' of South Korea's own with the painful memory of the 'Korean War'.

Coincidentally, the WALL is about to be removed as the nation is moving into the time of peace through 'The sunshine policy'. But our design plan is how to remodel it into park.

'THE DEFENSIVE WALL Against Tank' has its value as the issue related to peace in Korea, the final country with the Division within, so we plan to make it a part as the bridge to the 'Unification of Korea'.

Raising the possibility as a park, Symbol of Peace

3 Divisions
between North Korea
& South Korea

38th demarcation line

after the liberation
1945-1950
in the middle of the Korean Peninsula

Truce line

after Korean war
1955-
in the middle of the Korean Peninsula

The DEFENSIVE WALL against Tank

after Seoul Fortification Plan made by South Korea alone
1975-
in the Capital city of South Korea
Seoul



PEACE walls seoul / korea

The longing of all people for Unification of Korea

THE DEFENSIVE WALL Against Tank → THE PEACE walls for Unification of KOREAN

EDENING PLAN : DESIGN PLAN FOR ACHIEVE UNIFICATION OF KOREAN

It has been used a singular expenditure and building.



The expenditure of the wall change into the park



Divide the 3 walls into 10,000 pieces it means that the psychological distance between people & Wall is not far

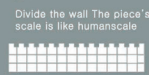

People can express the longing for Korea unification into the Pieces of the wall



It functions as a part of Mt. Bukhan, the wall would have the life.

Weave The Pieces by Nature (water & forest)



3 DEFENSIVE WALLS Against Tank

1st barrier
2nd barrier
3rd barrier

After all, we act in using landscape. And then, the PEACE WALL would become an issue worldwide and enhance the psychology for Korean union

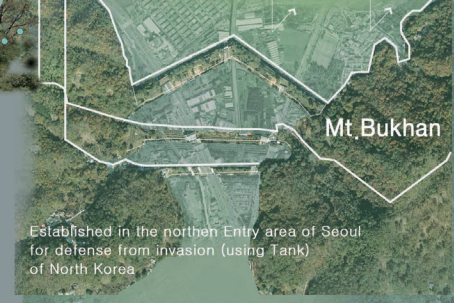

Established in the northern Entry area of Seoul for defense from invasion (using Tank) of North Korea

DESIGN A SCENARIO FOR ACHIEVE UNIFICATION OF KOREAN

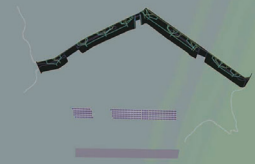

Let's enhance people's longing for Unification of Korean



STRUCTURE:
Community facilities into the wall

SCALE OF STRUCTION:
Humanscale space 20M X 20M

PROGRAM OF THE MEMORIAL ROLE
remain the shape of past one, the wall own
remain the texture ,concrete

HAND PRINT / LCD VIEWER PROGRAM
give a chance to people
to write on the side of each walls,
view information about Unification

library/community center/village office
/memorial park/High school
restoration in INTER-AGE spot
between The wall & Road
The wall demention is divided
100,000 unit on the surface



4 funtion Into 100,000 unit
The wall demention is divided
100,000 unit on the surface

Making PEACE WALL by organizing unit organized by the rule of topography/past shape of the wall/and nature

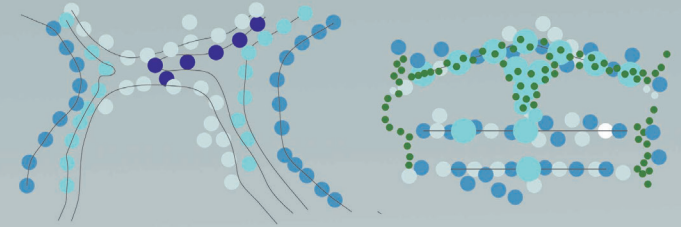

TO harmonize with Mt.Bukhan
the formation of units = contour around the wall

Harmonize with past shape
the formation of units has a powerful ecological funtion.



Build up the mound to connected
to Mt Bukhan in its natural shape.

The birth of PIECE WALL

The wall with the 4 funtion would be reorganized
by the ecolgic system of Mt.Bukhan.

As time goes on, there are 100,000 Handprints
on the wall.
If you can see ,you know our will for Unification.

landscape made by people
accumulated longing for Unificaion

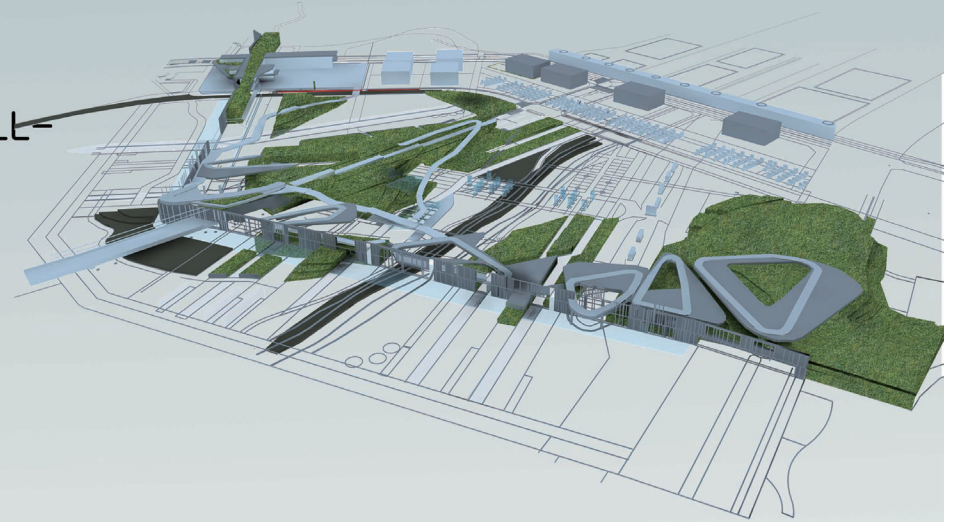

Established in the northern Entry area of Seoul
for defense from invasion (using Tank)
of North Korea

After community
facilities establish
in the wall,
People can knows
about their contry
- union

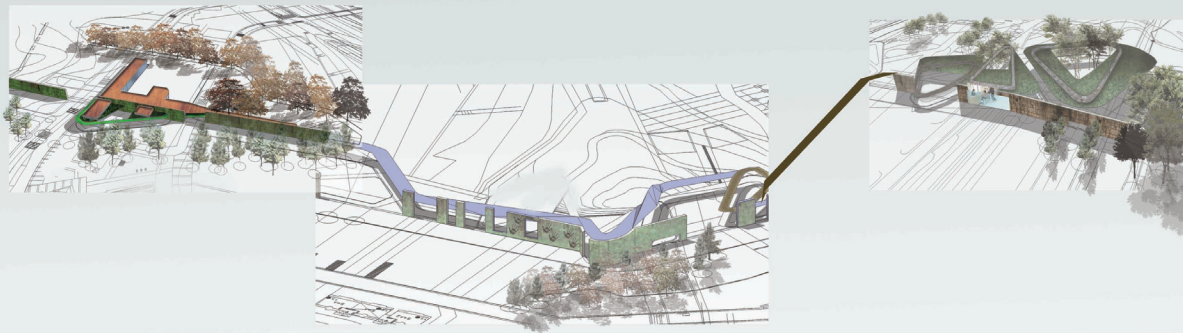
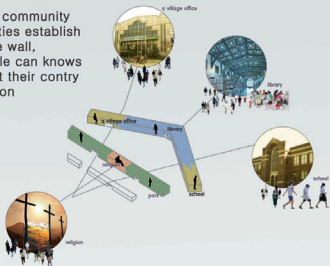

link community
community funtionin
in the interface

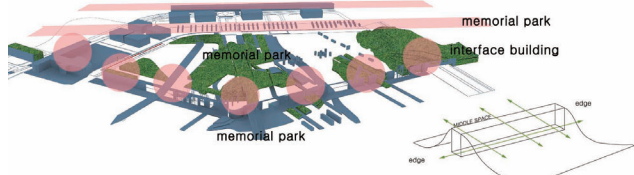

Established in the northern Entry area of Seoul for defense from invasion (using Tank) of North Korea

Build up the Mound with 10% slope that surrounds with walls

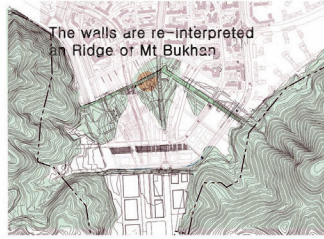

Link the Ridge between the wall & Mt. Bukhan so, we could attract the animals of Mountain.

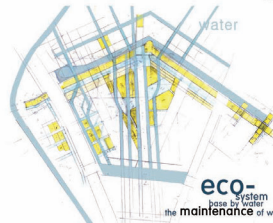

the wall would have the life because we plan the wall has Water & Forest function of Mt. Bukhan using underground water from Mt. Bukhan

TO harmonize with Mt. Bukhan the formation of units = contour around the wall

Harmonize with past shape the formation of units has a powerful ecological function.

The bi



interface spot & community road psychological distance between people & wall is close

3 walls are linking through a pass with a nice view though the pass, we could go up to Mt. Bukhan

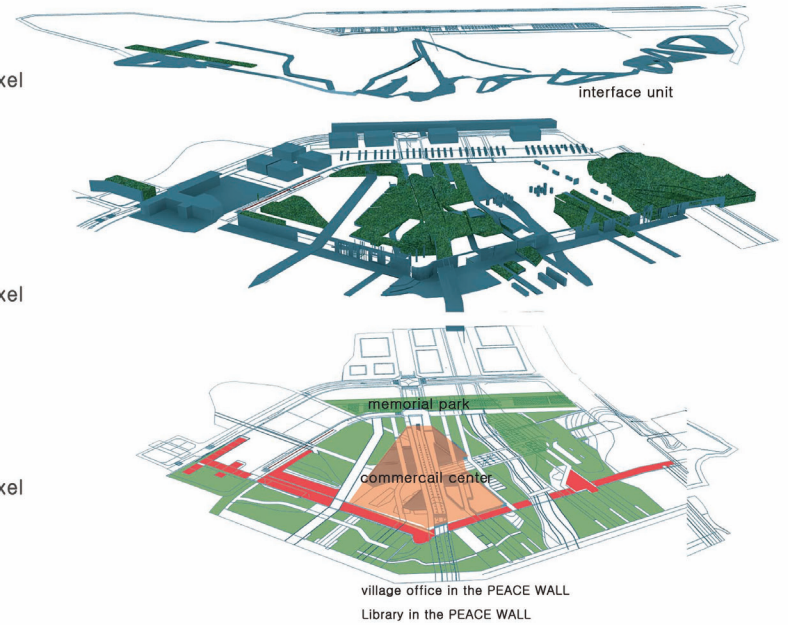
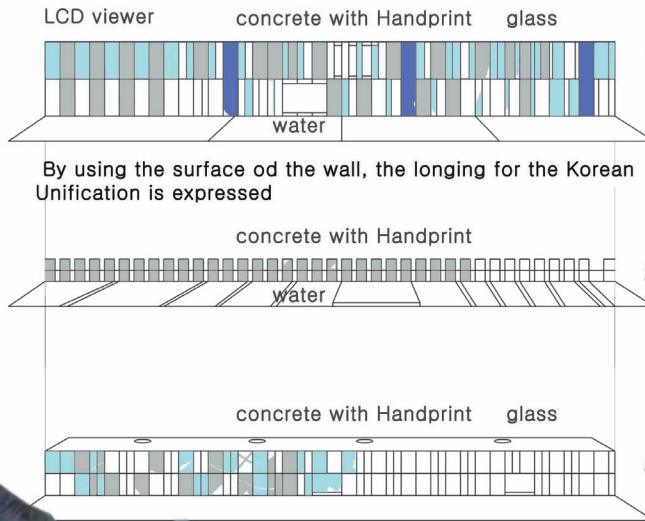

We felt the attraction to the site on reflecting the unique social image of Korea and worldwide special nature as the last remains of the Cold War era. And, we undertook the design with the great ambition to achieve the unification through the scenic view building up and accumulated scenic induction. Through this site sculpture design plan, the attempt is made to make the place as the national peace, life peach, and world famous site.



and print
people can write
the longing for Korea unification
is Handprint on the wall

accumulate
100,000 unit
size 20cm by 20cm
LCD & HANDPRINT

The longing of all people for Korean Unification,
The Hand print Would be accumulated as the Landscape
through the PEACE WALL

MASTER PLAN

The wall dimension is divided into
a large number of units of 20cmx20cm pixel
to grant various unification related program

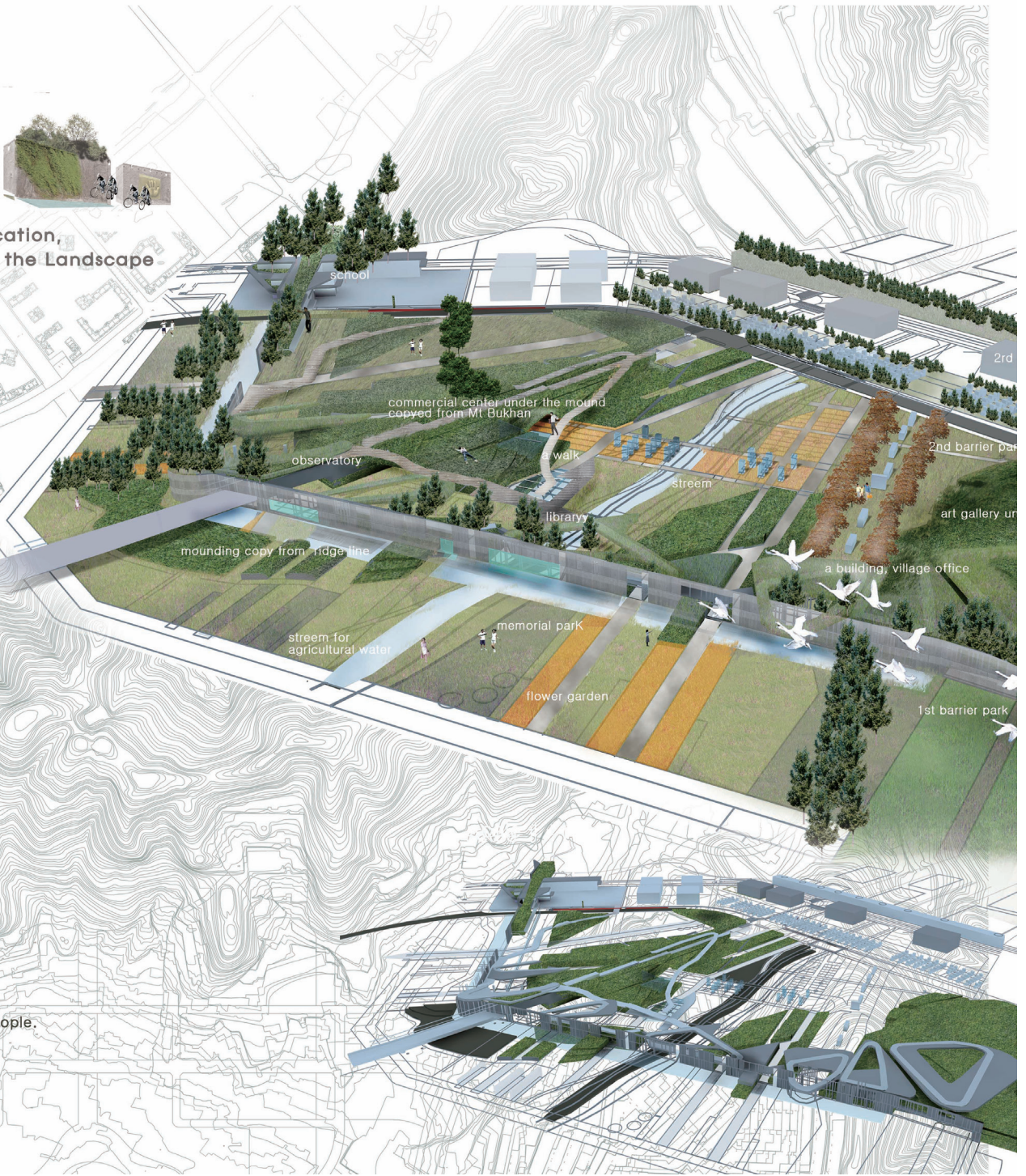
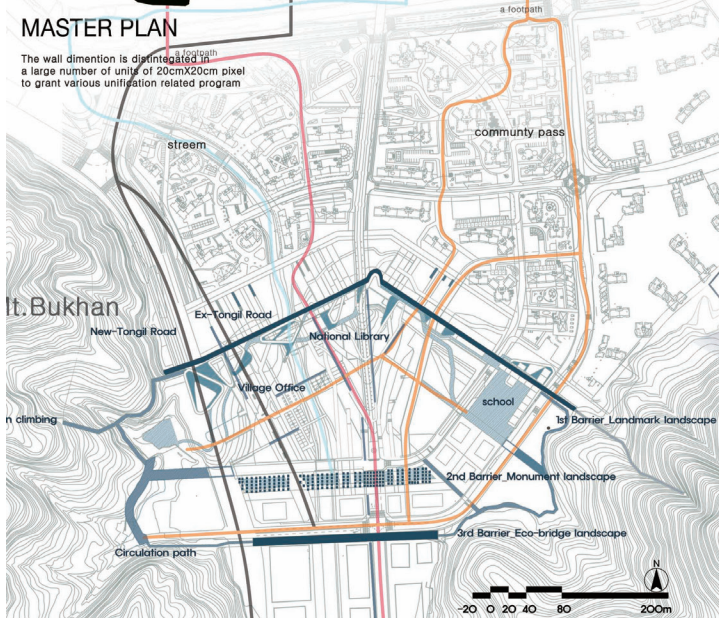

Consequently, it records 100,000 wills that long for unification,
and 100,000 units are accumulated as time passes by that the
great view to accumulate may be produced.
The design is not completed by the landscaper.
The landscaper simply prepares the white drawing paper and
the production of the scene is made up by the users for the one
and only longing of all people. It is to build up the scenic view by people.

SECOND PRIZE <i>IFLA Zvi Miller Prize</i>	TITLE AUTHOR(S) INSTITUTION	<i>Islandisland</i> Kwon Yu, Shin Joon-ho, Kim Hyo-jun, Lee Ji-hyun, Kwon Jung-sam University of Seoul, Seoul, Korea
---	--	--

JURY NOTES

This project involves the creation of a new landscape, connecting an existing green space with a new artistically developed artificial island, and breaking the barrier formed by the existing highways.

The design process was clearly and concisely illustrated through a series of simple sketches and diagrams, and convincing photo-realistic images. The graphic communication of this project was very highly developed, and very effective. This project was judged to be the most artistic entry in the competition.

There is a clear design intelligence evident in the project, and a very bright solution was proposed.

THIRD PRIZE <i>Merit Award</i>	TITLE AUTHOR(S) INSTITUTION	<i>Econtinuity: bringing back the future</i> Gullyawat Lertpeerakon, Anon Chitranukroh, Patsorn Kiattipongtilaworn, Sorakit Kitcharoenroj, Pranot Jarvanrattanaprapa Chulalongkorn University, Bangkok, Thailand
--	--	--

JURY NOTES

This project shows the redevelopment of waterfront lands, and the return of mangrove habitat on the coastline around the northern Thai gulf area. The project involved reclaiming the waterfront using multiple approaches, including wave breakers, wind turbines, and sustainable infrastructure, and eventually introducing mangrove seedlings which will ultimately form new landscape.

There were many good ideas evident in combination with good design. The presentation illustrated a systematic way of working. The project was graphically very clear and well organized.